

# YBW AIRPORT IMPROVEMENTS CLOSURES FOR PAVING TAXI C

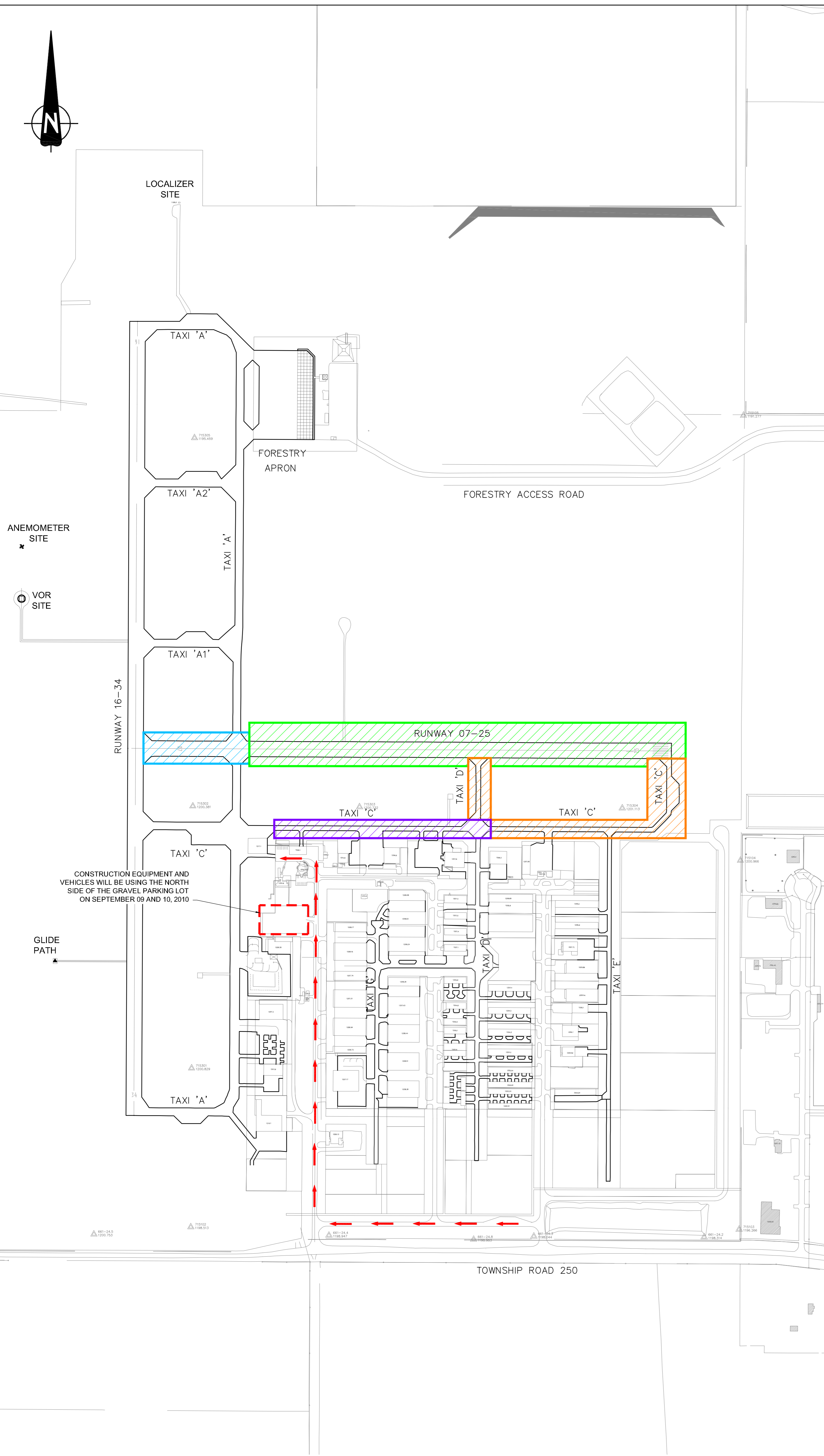

**SEPT. 09, 2010 AND SEPT. 10, 2010**

**5:00PM SEPTEMBER 09, 2010**

**RUNWAY 07-25 CLOSED.**

**TAXI C EAST OF TAXI D CLOSED.  
TAXI D NORTH OF TAXI C CLOSED.**

**RUNWAY 07-15 WEST OF TAXI A AVAILABLE  
FOR TAXIING AIRCRAFT.**

**11:00PM SEPTEMBER 09, 2010**

**RUNWAY 07-25 REMAINS CLOSED - OPEN  
FOR TAXI AIRCRAFT WEST OF TAXI A**

**TAXI C EAST OF TAXI D REMAINS CLOSED.  
TAXI D NORTH OF TAXI C REMAINS CLOSED.**

**TAXI C WEST OF TAXI D CLOSSES.**

**7:00AM SEPTEMBER 10, 2010**

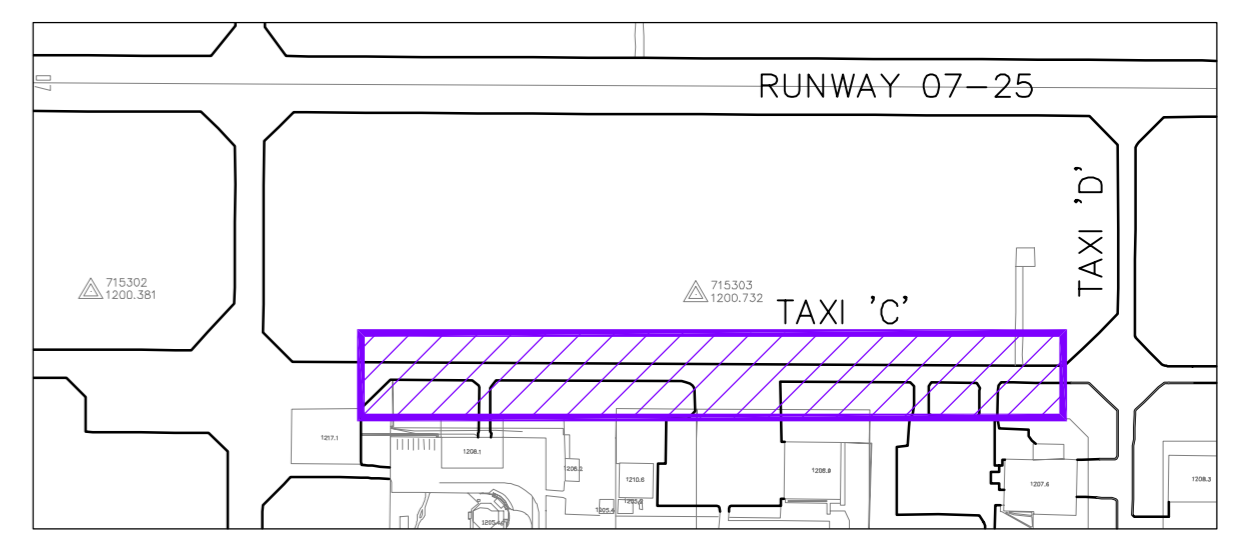

**RUNWAY 07-25 OPENS.  
TAXI C EAST OF TAXI D OPENS.  
TAXI D NORTH OF TAXI C OPENS.**

**TAXI C WEST OF TAXI D CLOSED UNTIL  
PAVING FINISHED ~9:00AM.**